

MIBRAG

Kraftwerk-Wäldle

5

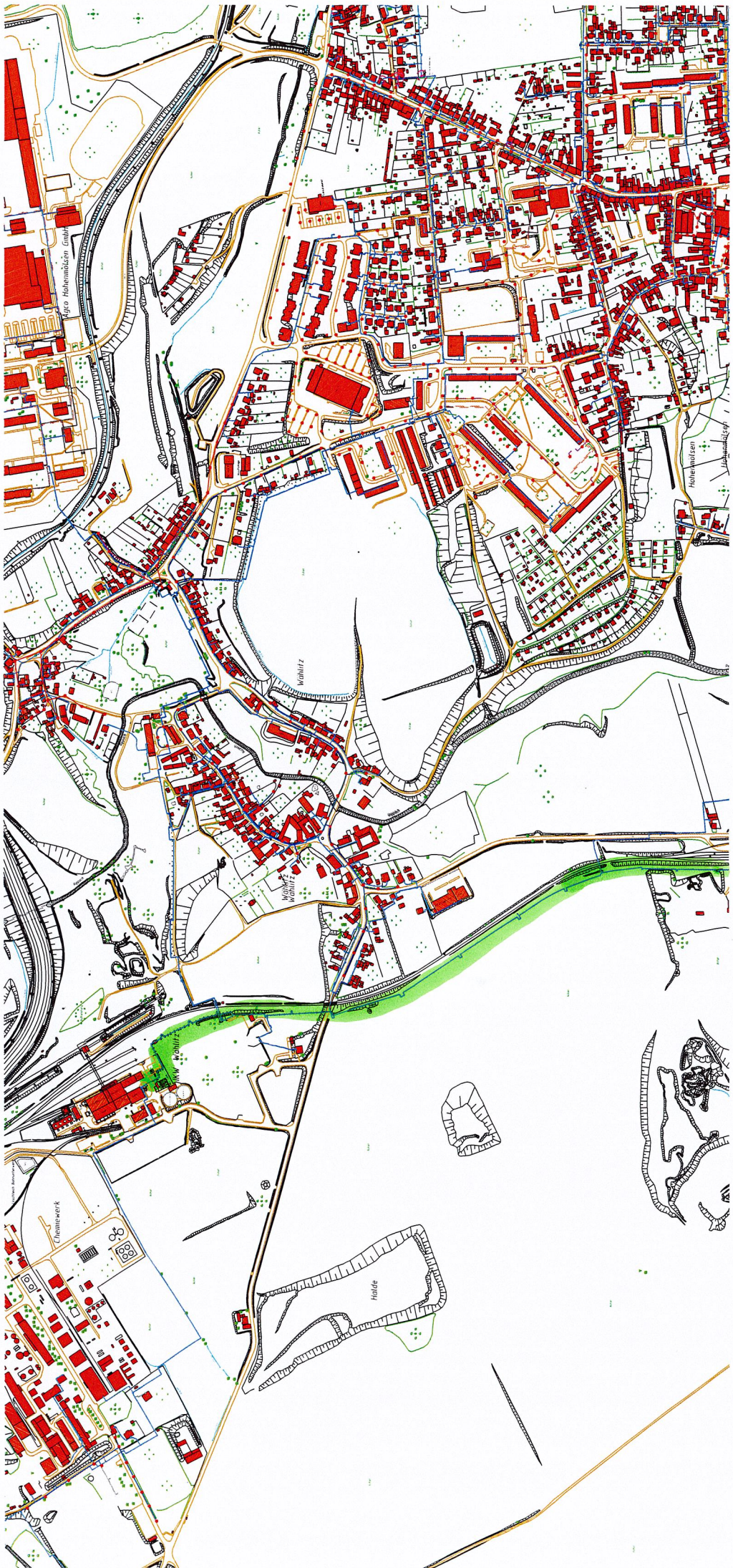

Trasse DN 400 goplast

4



③

parallel zu vorhandener Trasse DN 300

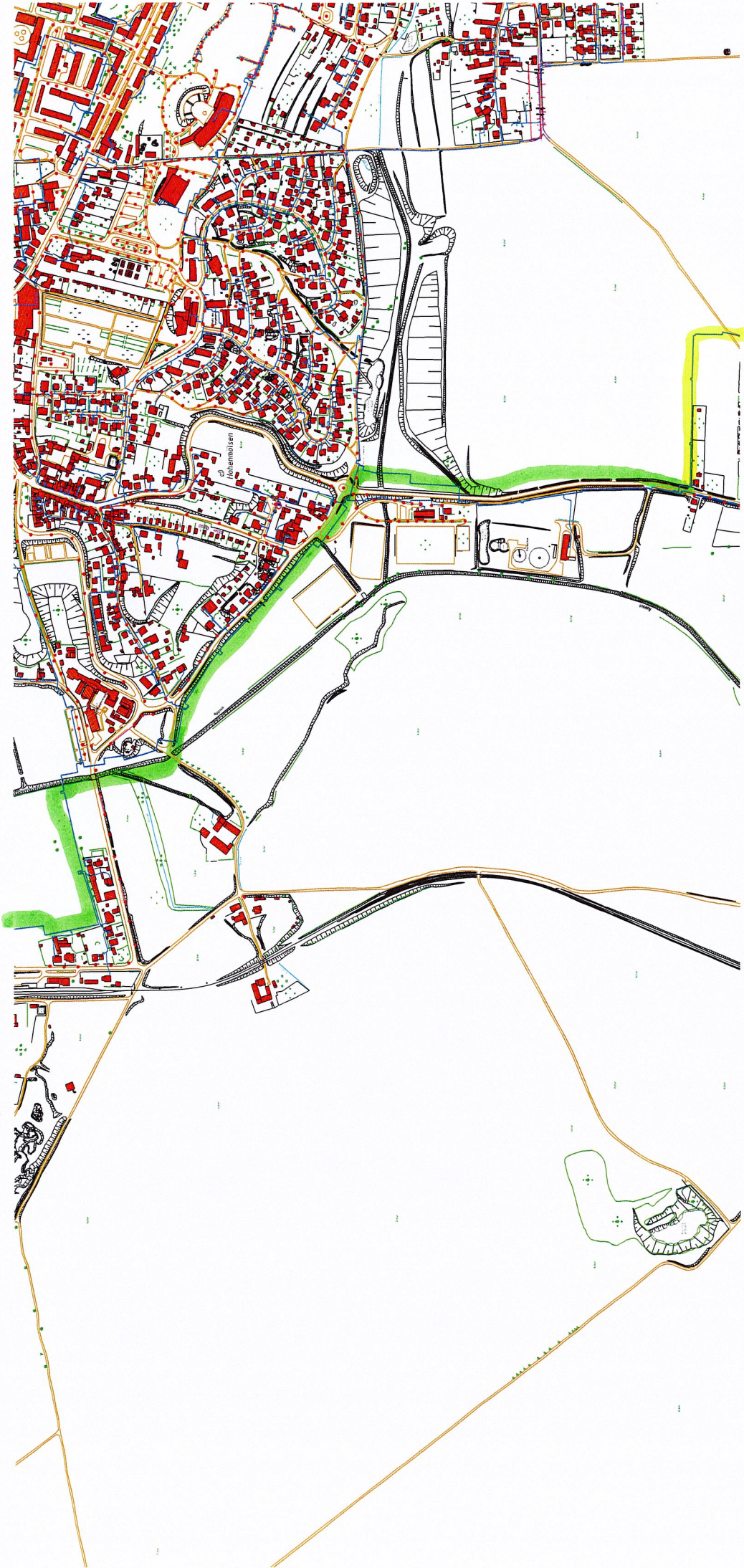

2

OT-Zembschen
Endpunkt Trasse DN 250 am Präper 10,6 km

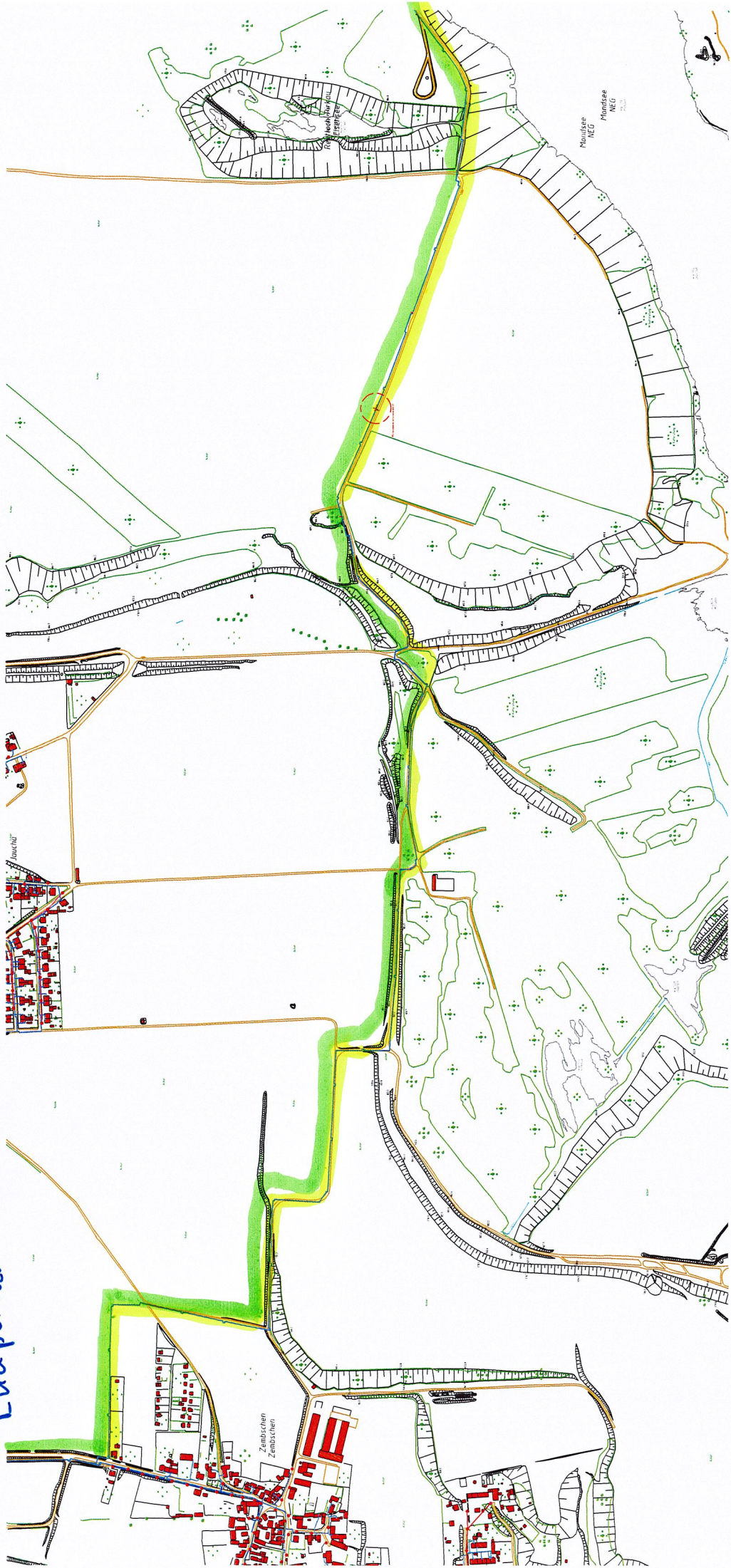

1

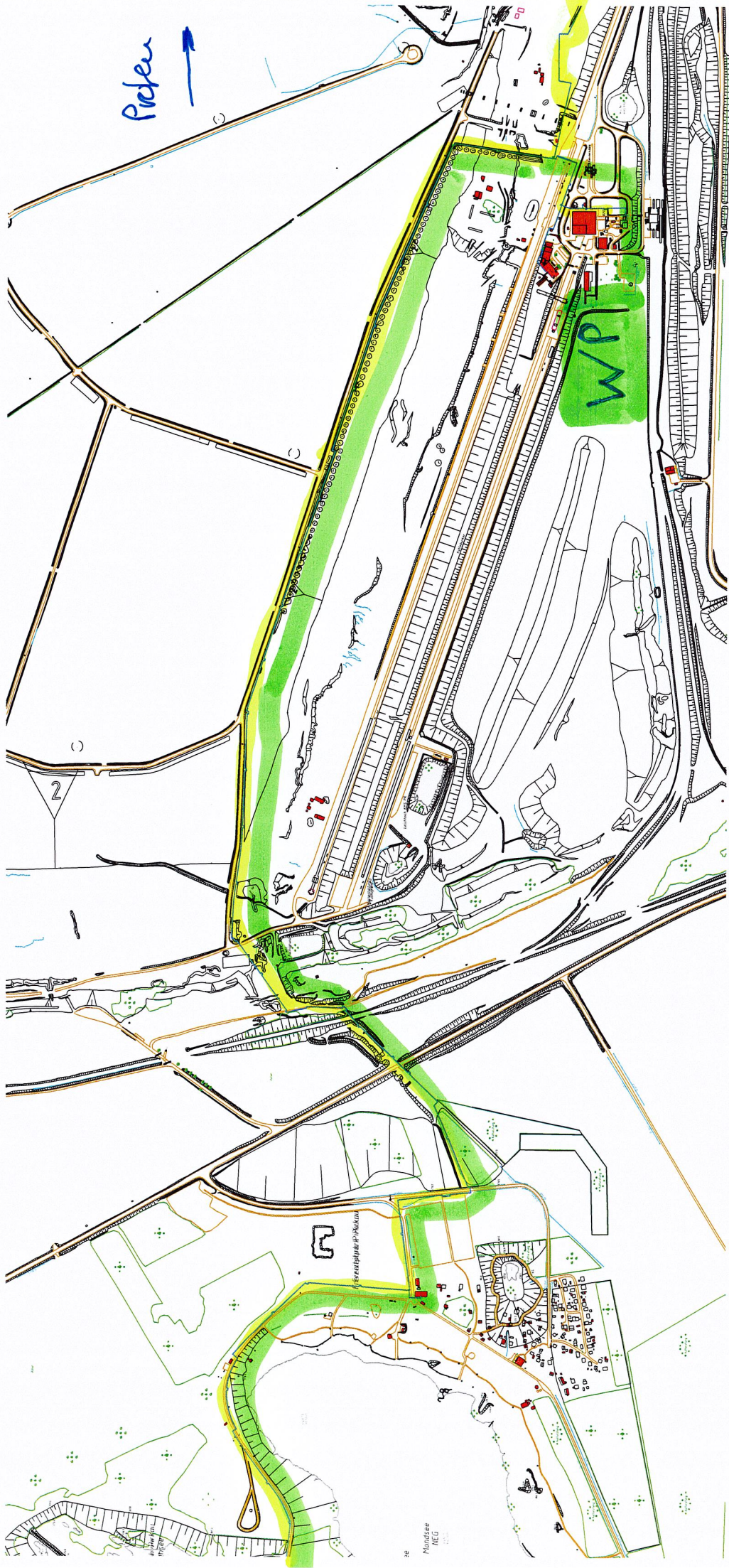

Pöfken →

von Pöfken - HFM

Vorhandene FW-Trasse DN 250

OT-Zeimbereich ~ 10,6 km



Großwärmepumpe Kohle-Misch-Steapelplatz
KMS